

Overview:

The VRM-AX61221TM is a 2U Rackmount Chassis for Standard ATX Motherboard.



Features:

- Supports 12" x 9.6" standard ATX Motherboard
- Internal 2 x 3.5" drives
- Front-accessible one 3.5", one 5.25" and one slim CD-ROM

Specifications:

- **Standard Color-** Black
- **Construction** – Heavy-duty cold-rolled steel
- **Form Factor-** 12" x 9.6" ATX Motherboard
- **Drive Capacity** – Exposed 1x slim-line CD, 1 x 3.5" & 1 x 5.25", internal 2 x 3.5" HDD's or Exposed 1 x slim-line CD & 1 x 3.5" drives; internal 3 x 3.5" HDDs
- **Cooling-** One 8cm ball-bearing fan
- **Front Panel Indicators** – 1 x power on/off; 1 x HDD
- **Front Panel Controls-** 1 x power on/off; 1 x system reset
- **Front Panel Connectors** – 2 x USB
- **Optional Expansions-** PCI riser card with 3 slot 32-bit
- **Speaker** – One 0.3W speaker
- **Operating Temperature Range-** 0°C to 40C (32°F to 104)
- **Dimensions-** 19" W x 19.6 x 3.5"

Power Supply Options:

Items	Input	Output	MTBF
ATX 250W	AC 115/230V	+5V @ 25A, +12V @ 13A, -5V @ 0.5A, -12V @ 0.5A, +3.3V @ 14A, +5V @ 2A	100,000 hours
ATX 300W	AC 115/230V	+5V @ 30A, +12V @ 15A, -5V @ 0.5A, -12V @ 0.5A, +3.3V @ 14A, +5v @ 2A	100,000 hours
ATX 400W (PFC)	AC 100/240V auto	+5V @ 30A, +12V @ 18A, -5V @ 0.5A, -12V @ 0.8A, +3.3V @ 28A, +5V @ 2A	Over 50,000 hours

Dimensions:

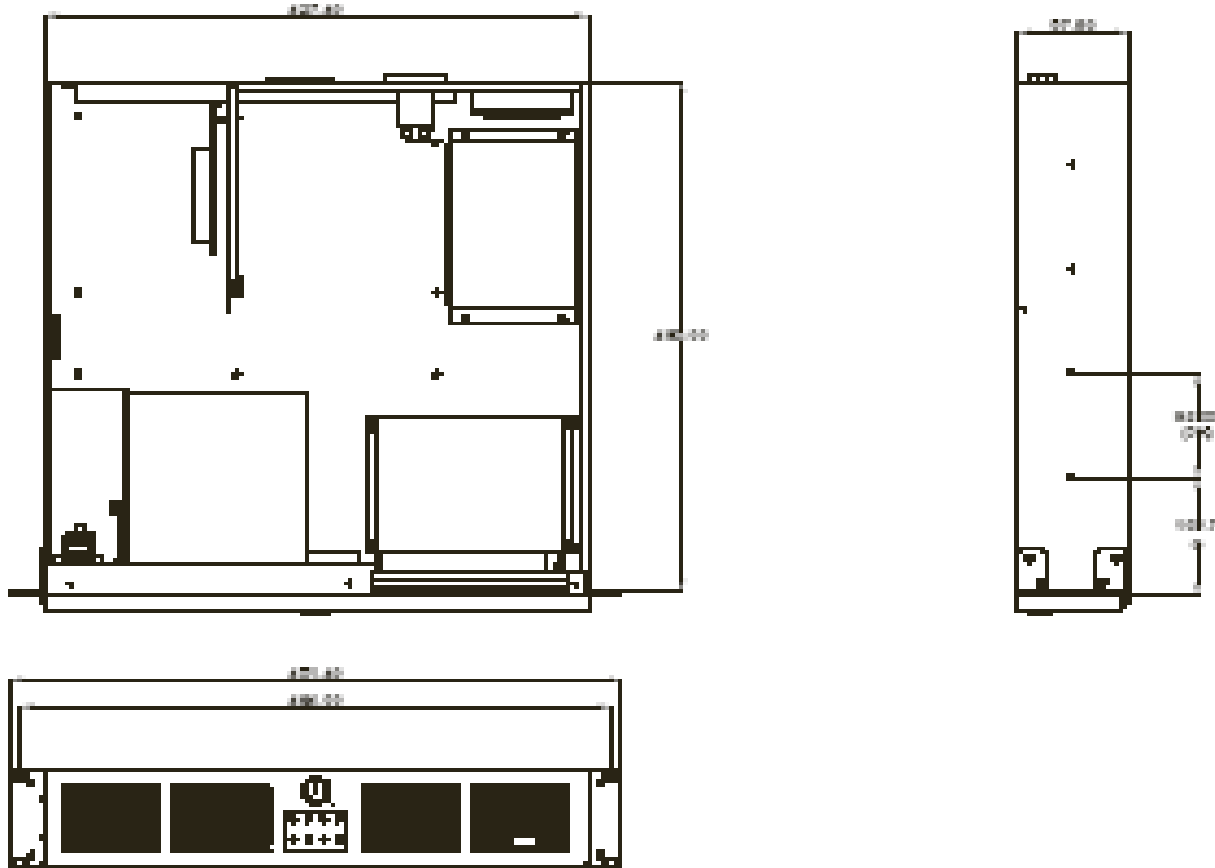

Ordering Options:

- VRM-AX61221TM/X250:** 2U rackmount chassis, ATX 250W power supply.
- VRM-AX61221TM/X300:** 2U rackmount chassis, ATX 300W power supply.
- VRM-PCI 3:** 3-slot PCI 32-bit riser card
- VRM-AX96114:** 3-slot PCI 32-bit riser card with flat cable
- VRM-AX96118:** 2-slot PCI 64-bit riser card
- VRM-SR20:** 20" slide rail
- VRM-AX-SLCD:** Slim-line CD-ROM
- VRM-AX-SLCDR:** Slim-line CD-RW
- VRM-ATX250W** power supply with PFC
- VRM-ATX300W** power supply with PFC